

DO IT YOURSELF

with the experts on-hand

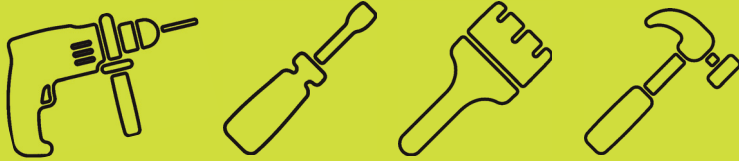

How to tile...

Large Format Tiles to Plaster and Plasterboard (Dry Areas)

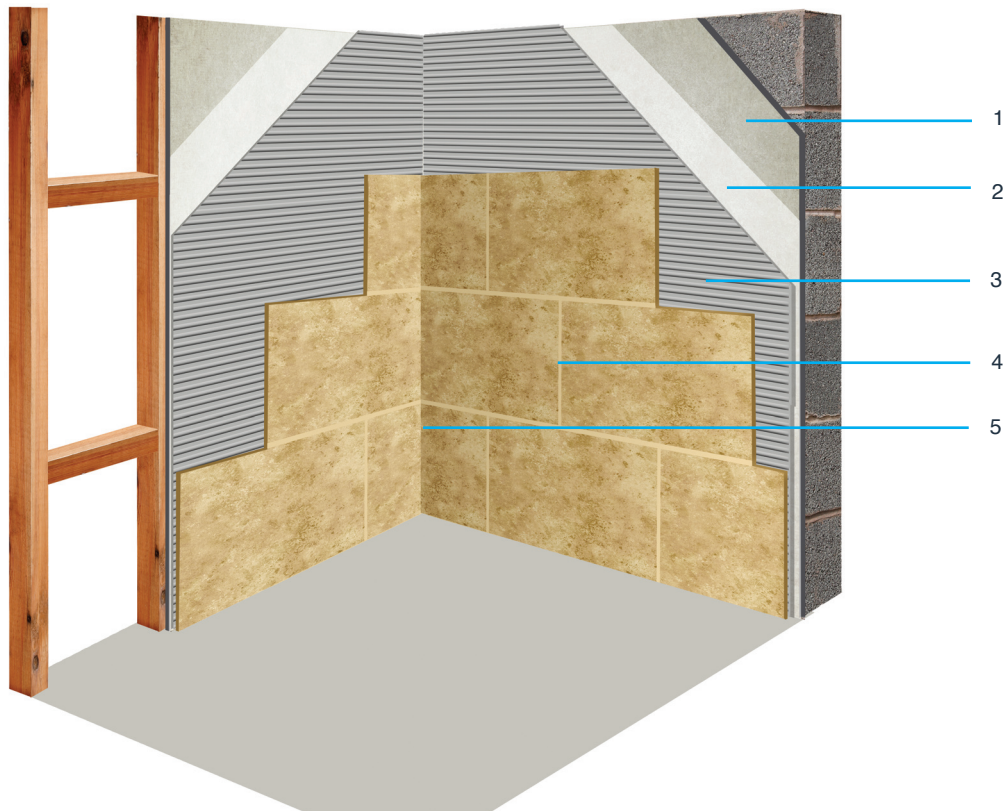

1. Either screw plasterboard to stud frame wall construction at maximum 600mm centres, or apply gypsum plaster to block work. Ensure surfaces are dust free and clean.
2. Prime the surfaces with diluted Nicobond Universal Bonding Agent and Sealer and allow to dry.
3. Apply the recommended adhesive onto the wall. Install tiles ensuring good contact between the tiles and adhesive. For large format tiles of 60 x 30cm or larger it is advisable to apply the adhesive using the 10mm square Nicobond Notched Trowel. This will enable bedding out of the adhesive to accommodate any curvature in the tiles.
4. Fill joints between tiles using recommended grout.
5. Ensure movement joints are inserted into internal corners, PVC type or silicone sealant.

* New plaster needs to dry for at least 4 weeks. Tiles to be fixed to finish coat only, never the backing coat. When fixing to Plaster board ensure the boards are rigidly braced and adequately supported, fix directly to the paper face, do not skim with plaster. Weight of tiling not to exceed 32kg/m² on plasterboard and 20kg/m² onto gypsum plaster. For details of fixing large format tiles to alternative substrates or in wet areas please contact Nicobond Technical Team.

* It should be noted that a large format tile is a tile with no tile edge greater than 1200mm (nominal) or a facial area greater than 3600cm².