

DO IT YOURSELF

with the experts on-hand

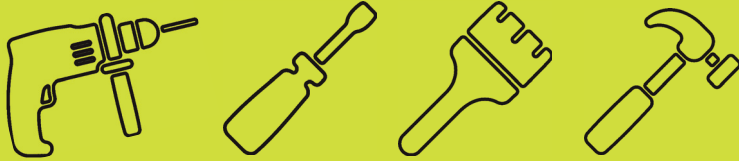

How to...

Fix Nicobond Tile Backer Board to Solid Walls

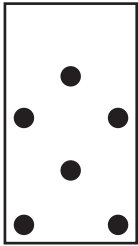

2. Apply dots of adhesive to the reverse side of the board (max 300mm centres).



4. Hammer-In fixings to provide a secure installation of the Tile Backer Board.



Nicobond Hammer-In fixings

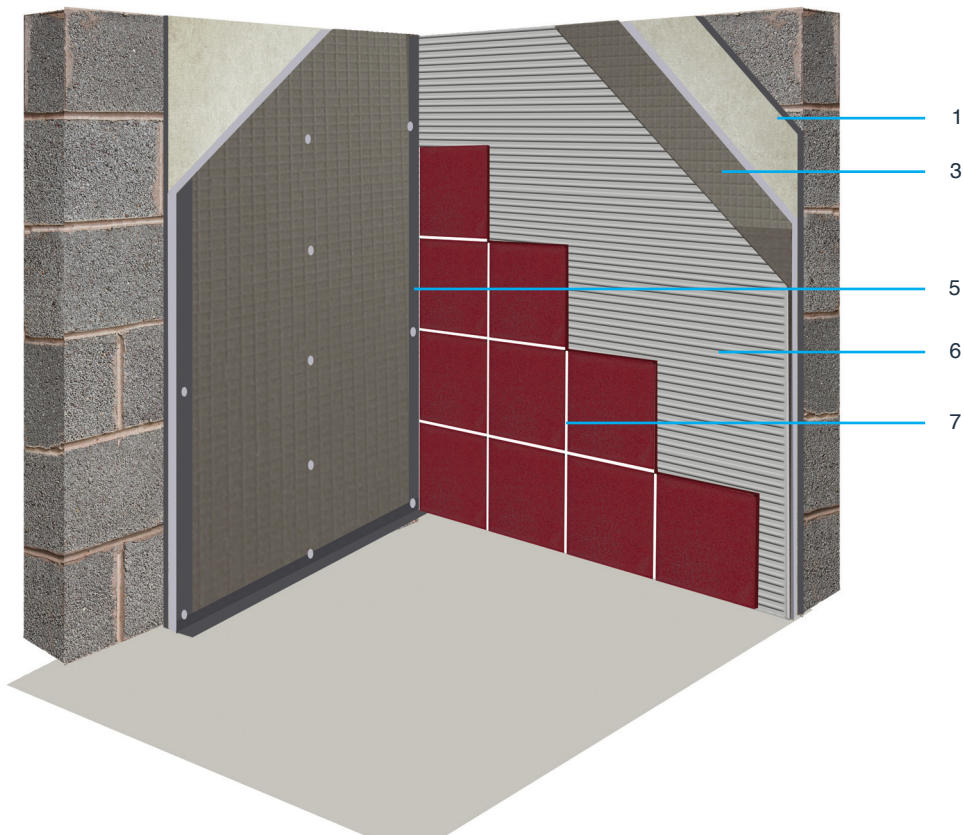

1. Ensure the wall surface is sound and free from dust and grease.
2. Using Nicobond Quickfix apply dots of adhesive to the reverse side of the board. A 600 x 2400 x 12.5mm thick board will typically have 12 dots of mortar up to 30mm thick, ensure outer dots are located at board edges.
3. Offer up the board vertically to the wall surface and bed firmly into place. Always use a straight edge and level to ensure good alignment.
4. Once the adhesive has set use the Hammer-In fixings to provide a secure installation of the Tile Backer Board. The fixings to be positioned so as to be hammered in through the middle of the dot of adhesive.
5. The joints between boards should be taped over using either Nicobond Jointing Tape for dry areas or Nicobond Wet Room Waterproof Tape and components for wet areas.
6. Spread the recommended adhesive over the surfaces and fix new tiles using the notched trowel or solid bed method as appropriate.
7. Fill joints between tiles using recommended grout.

* The dot and dab fixing system is not recommended for use with boards less than 12.5mm thick. For the thinner boards, using a notched trowel apply a solid bed of adhesive over the board surface and press firmly into position.