

DO IT YOURSELF

with the experts on-hand

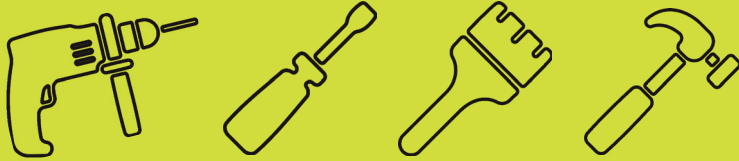

How to...

Fixing Mesh Backed Mosaics onto Various Substrates

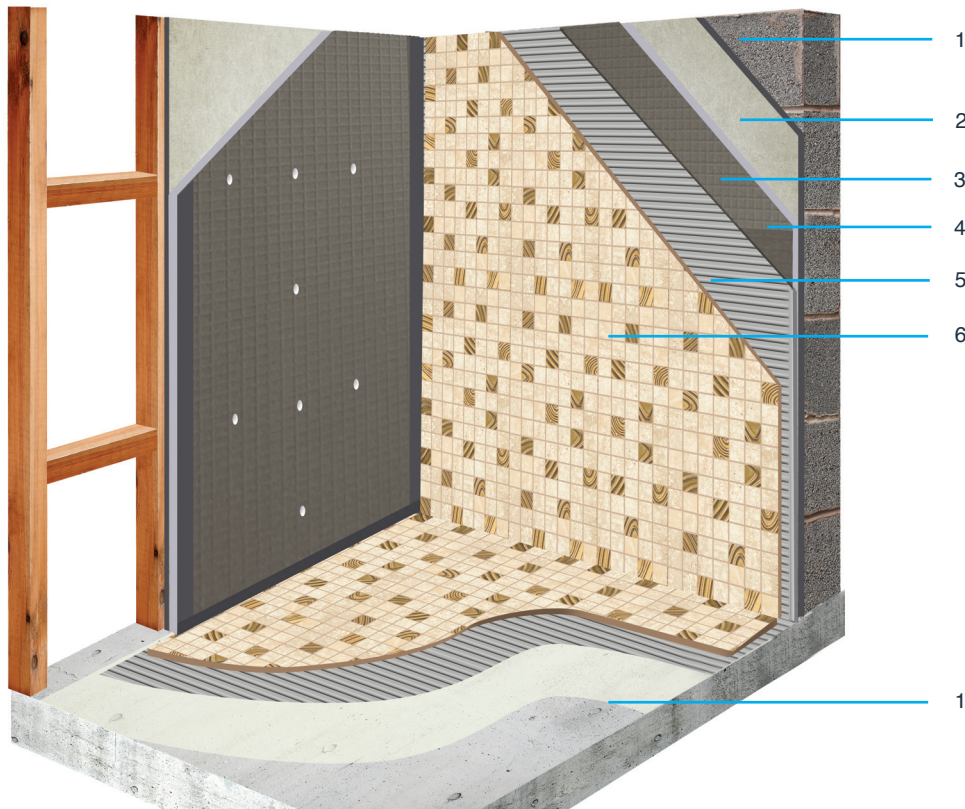

1. Ensure the sand:cement screed or concrete is fully cured, flat and clean. If the base is porous, prime with diluted Nicobond Primer in ratio 4 volumes of water to 1 volume of Nicobond Primer and allow to dry.
2. Either screw plasterboard to stud frame wall construction at maximum 600mm centres, or gypsum plaster if fixing onto block work.
3. Overlay plasterboard/gypsum plaster substrate with 12mm Nicobond Tile Backer Board. Use Nicobond Screws and Discs at 400mm centres to the substrate. Boards should be cross bonded and screws recessed.
4. Cover joints between boards with Nicobond Jointing Tape. Seal corners with Nicobond Wet Room Waterproof Tape and Internal Corners.
5. Apply a layer of adhesive onto the substrate and lightly comb the surface using a Nicobond Notched Trowel. Offer the sheet of mosaic up and bed the mesh side into the adhesive layer and smooth the sheet with a flat trowel to ensure good contact between the mesh and the adhesive.
6. Once the adhesive has set firm i.e. the following day, the joints may be grouted using the same Nicobond Mosaic Adhesive and Grout.

* The backing mesh should not occupy more than 25% of the area of each tessera as this will affect the performance of the Mosaic Adhesive and Grout. In wet areas the backing material should be water resistant. * Cement:Sand render should be left for 2 weeks before tiling is applied. (BS 5385 : Part 1)