

# How to tile onto...

## Plaster and Plasterboard using Large Format Tiles

\*New plaster needs to dry for at least 4 weeks. Tiles to be fixed to finish coat only, never the backing coat. When fixing to Plaster board ensure the boards are rigidly braced and adequately supported. Fix directly to the paper face, do not skim with plaster. Weight of tiling not to exceed 32kg/m<sup>2</sup> on plasterboard and 20kg/m<sup>2</sup> onto gypsum plaster.

For details of fixing large format tiles to alternative substrates or in wet areas please contact our technical team.

\* It should be noted that a large format tile is a tile of at least one edge greater than 600mm (nominal) or a facial area greater than 3500cm<sup>2</sup>.

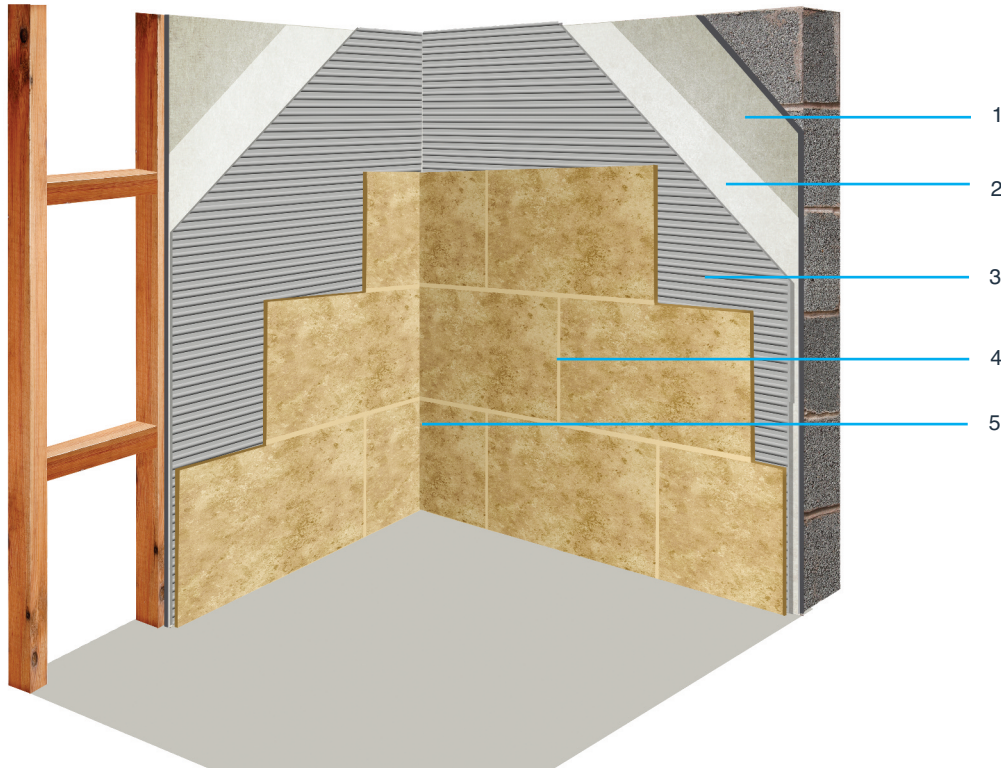

1. Either screw plasterboard to stud frame wall construction at maximum 600mm centres apart, or apply gypsum plaster to block work. Ensure surfaces are dust free and clean.
2. Prime the surfaces with diluted Nicobond Universal Bonding Agent and Sealer and allow to dry.
3. Apply the recommended adhesive onto the wall. Install tiles ensuring good contact between the tiles and adhesive. For large format tiles of 60 x 30cm or larger it is advisable to apply the adhesive using the 10mm square Nicobond Notched Trowel. This will enable bedding out of the adhesive to accommodate any curvature in the tiles.
4. Fill the joints between tiles with the recommended grout using a float grouter. Remove surplus grout from the surface with a sponge and smooth the joints with a rounded stick to achieve an even better finish.
5. Ensure movement joints are inserted into internal corners, PVC type or silicone sealant.

### Recommended Tile Adhesives



Nicobond Unique



Nicobond Ultragrip

### Recommended Tile Grout



Nicobond Flexible Grout Plus



Nicobond Tilers Grout

### Featured Products



Nicobond Universal Bonding Agent and sealer



## Manufacturing Tiling Solutions Since 1958

### N&C Tiles & Bathrooms Trade Counters & Showrooms

1A - 1B Alexander Place  
Lower Park Road, New Southgate  
**London N11 1ST**  
Tel: 020 8361 6050  
Fax: 020 8361 4757

8 Ascent Park, Edinburgh Way  
**Harlow, Essex CM20 2HW**  
Tel: 01279 621980  
Fax: 01279 621981

14 Meridian Trading Estate  
Bugsby Way, Charlton  
**London SE7 7SJ**  
Tel: 020 8269 5960  
Fax: 020 8269 5961

1 Cliffside Trade Park, Motherwell Way  
**Lakeside, West Thurrock**  
Essex RM20 3XD  
Tel: 01708 680180  
Fax: 01708 680181

16 Arlington Business Park  
Whittle Way, **Stevenage**  
Hertfordshire SG1 2BD  
Tel: 01438 315400  
Fax: 01438 740338

9 - 11 McDonalds Business Park  
Maylands, **Hemel Hempstead**  
Hertfordshire HP2 7EB  
Tel: 0845 2606 025  
Fax: 0845 2606 026

8D Pompey Centre, Fratton Way  
Southsea, **Portsmouth PO4 8TA**  
Tel: 02392 894599  
Fax: 02392 894598

5 Tower Court, St David's Road  
Swansea Enterprise Park  
**Swansea SA6 8QL**  
Tel: 01792 797337  
Fax: 01792 774019

### N&C Tiles & Bathrooms Distribution Centres, Trade Counters & Showrooms

N&C Building Materials  
41 - 51 Freshwater Road  
Chadwell Heath  
**Romford, Essex RM8 1SP**  
Tel: 020 8586 4600  
Fax: 020 8586 4646

C1 Cothill Trading Estate  
Plympton, **Plymouth PL7 1SR**  
Tel: 01752 339724  
Fax: 01752 342746

B1 - B3 Sneyd Trading Estate  
Sneyd Hill, Burslem  
**Stoke on Trent ST6 2PA**  
Tel: 01782 575727  
Fax: 01782 575641

26 Colquhoun Avenue  
Hillington, **Glasgow G52 4BN**  
Tel: 0141 880 1200  
Fax: 0141 880 1212

4 Waterloo Industrial Estate  
Flanders Road, Hedge End  
**Southampton SO30 2QT**  
Tel: 01489 779700  
Fax: 01489 779701

3 - 4 Cardiff Trade Park  
Hadfield Road, **Cardiff CF11 8AQ**  
Tel: 02920 390146  
Fax: 02920 224356

2 City Park, Industrial Estate  
Gelder Road, **Leeds LS12 6DR**  
Tel: 0113 224 4630  
Fax: 0113 224 4631

2 - 5 Albarn Close  
Wyncolls Road, Severalls Park  
**Colchester, Essex CO4 9HY**  
Tel: 01206 844 161  
Fax: 01206 845 878

 Follow us:  
NCGroupLtd

 Find us:  
Nicholls and Clarke Group of Companies

 Subscribe to us:  
Nichollsandclarke